

Panel cut-out

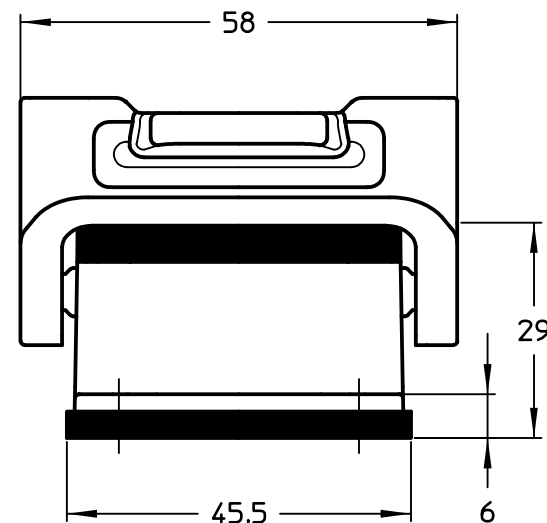
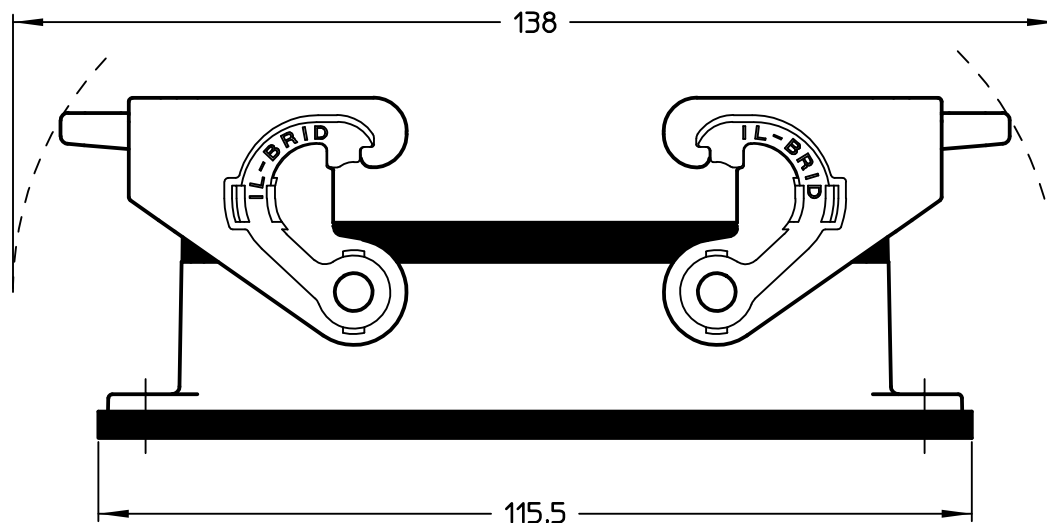
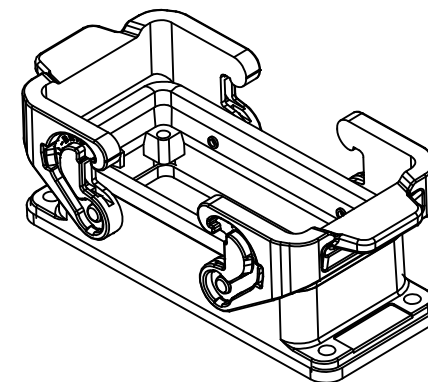

| | | | |
|------------------|---|--|-------|
| | Simplified representation with dimensions without tolerance | | |
| Original Size A4 | CLI 16 bulkhead mounting housing size "77.27", with 2 IL-BRID levers | | Scale |
| Date 22/02/22 | | | 1:1 |
| Sign. G. Renna | | | |